

Arriving by car, you will enter the Mirabell Palace via Rainerstraße. By foot you can also enter the Mirabell Palace via Mirabell Gardens or Rose Hill. Considered from the entry Rainerstraße, you will find the Wolf-Dietrich Hall at the end of the parking place. There you can take the Marble Stairs by foot on the right hand side. The more you can take the barrier-free way on the left hand side by elevator.

www.stadt-salzburg.at/standesamt
www.mysalzburgwedding.com

Continue on page 2 -->

Plan overview Mirabell Palace
Entry civil registry office

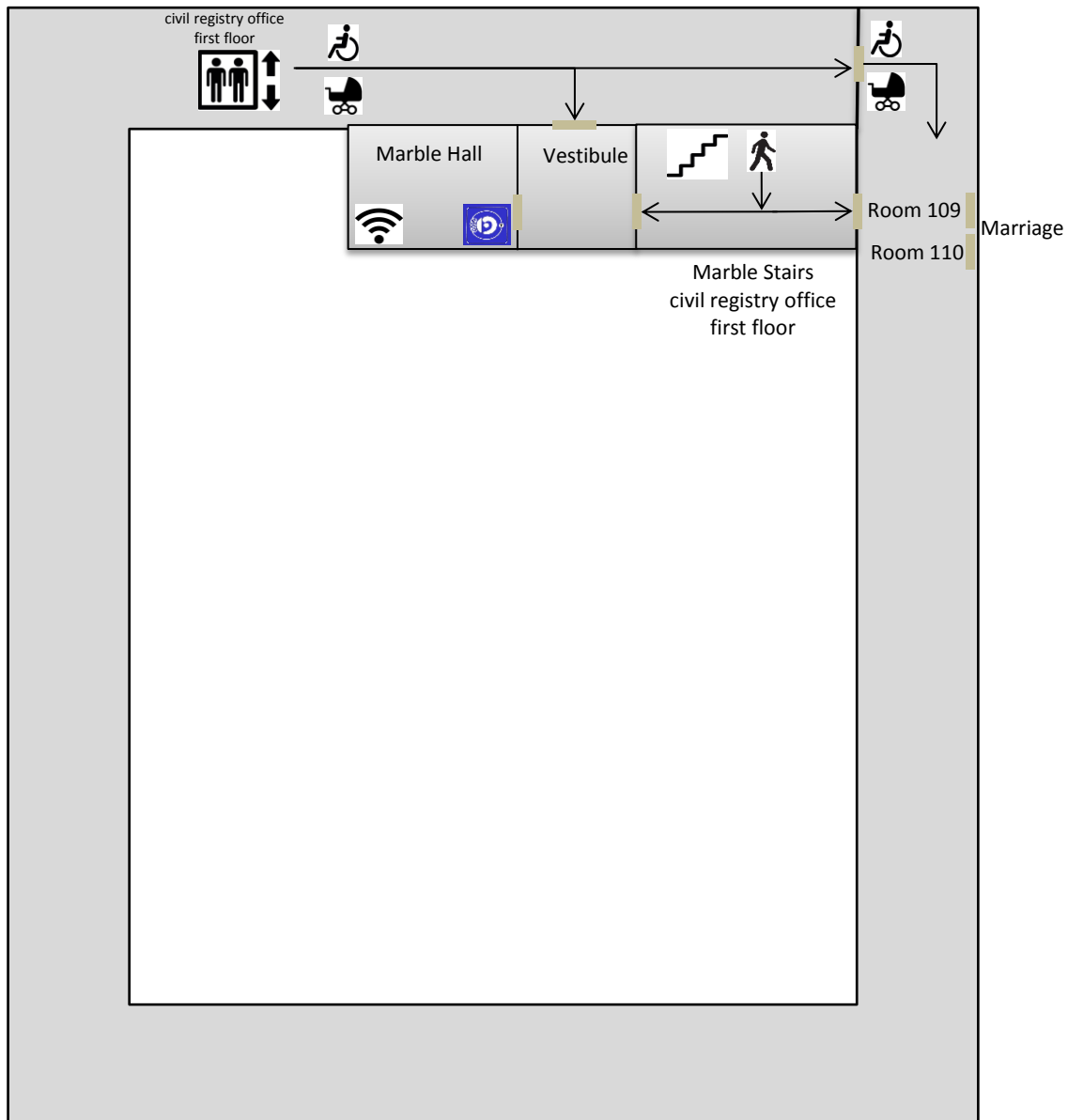

Reaching first floor by elevator, please follow the corridor in front of you to reach the civil registry office.
Reaching first floor via Marble Stairs, you will find the civil registry office on your left hand side and the Marble Hall on your right hand side.